

MANUALE D'ISTRUZIONI APPLIQUE IP65



NASSO

ZEA

Specifiche tecniche:

	MISURE	W	Lumen	AC/Hz	3CCT (SWITCH)	CRI	α	TEMP. LAVORO	FINITURA	FLICKER	DIMM.	CLASSE	IK
IPN6WS	160*100*40mm	6	400	AC180-250V Hz 50/60	3000/4000/6500K	80	38**6	-20°+40°	BIANCO	FREE	NO	II	08
IPN6BS	160*100*40mm	6	400	AC180-250V Hz 50/60	3000/4000/6500K	80	38**6	-20°+40°	NERO	FREE	NO	II	08
IPN8WS	210*100*40mm	8	550	AC180-250V Hz 50/60	3000/4000/6500K	80	38**8	-20°+40°	BIANCO	FREE	NO	II	08
IPN8BS	210*100*40mm	8	550	AC180-250V Hz 50/60	3000/4000/6500K	80	38**8	-20°+40°	NERO	FREE	NO	II	08

Applique a parete up&down a sei o otto luci, facilmente installabile e inseribile in ogni contesto architettonico. Corpo e diffusore V2 autoestinguente e Anti-UV in policarbonato termoplastico e staffa in lega di alluminio. Disponibile in due finiture: bianco e nero. Resistente agli urti.

1

⚠ ATTENZIONE

Si raccomanda di rivolgersi a un elettricista qualificato per installare il prodotto.

Si raccomanda di non toccare il prodotto quando è acceso.

In caso di malfunzionamento, staccare la lampada dall'alimentazione.

Si raccomanda di rivolgersi a un elettricista e di non provare a riparare la lampada da soli.

MONTAGGIO

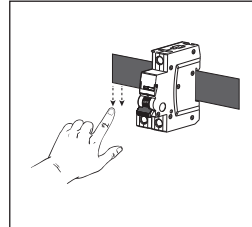

1. Scollegare la corrente elettrica.

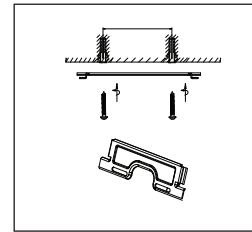

2. Scegliere la posizione desiderata per installare la staffa.

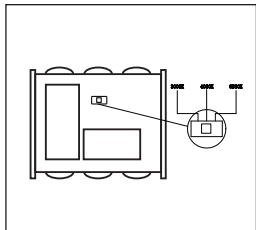

3. Selezionare la temperatura e collegare il cavo di corrente.

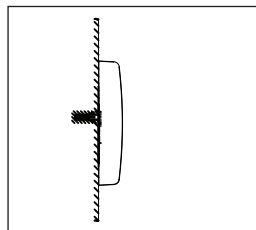
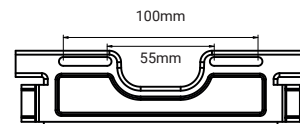

4. Spingere il prodotto verso l'alto nella staffa.

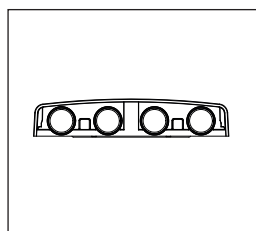

5. La lampada è pronta all'uso.

Informazioni sul riciclaggio in conformità con le direttive RAAE e batterie



Simbolo sul prodotto



Simbolo sulla batteria

Solo Europa

Il prodotto/batteria è contrassegnato con uno dei simboli di riciclaggio sopra indicati. Questo indica che a fine vita il prodotto/batteria, dovrà essere smaltito/a separatamente in appropriati luoghi di raccolta e non con i normali rifiuti domestici.

CE RoHs

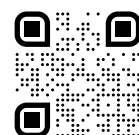

IPERLUX®
www.iperlux.com
info@iperlux.com

INSTRUCTION MANUAL APPLIQUE IP65



NASSO

ZEA

Specifications and Technical Data sheet :

	SIZE	W	Lumen	AC/Hz	3CCT (SWITCH)	CRI	α	AMB. TEMP.	FINISH	FLICKER	DIMM.	CLASS	IK
IPN6WS	160*100*40mm	6	400	AC180-250V Hz 50/60	3000/4000/6500K	80	38°*6	-20°+40°	WHITE	FREE	NO	II	08
IPN6BS	160*100*40mm	6	400	AC180-250V Hz 50/60	3000/4000/6500K	80	38°*6	-20°+40°	BLACK	FREE	NO	II	08
IPN8WS	210*100*40mm	8	550	AC180-250V Hz 50/60	3000/4000/6500K	80	38°*8	-20°+40°	WHITE	FREE	NO	II	08
IPN8BS	210*100*40mm	8	550	AC180-250V Hz 50/60	3000/4000/6500K	80	38°*8	-20°+40°	BLACK	FREE	NO	II	08

Six or eight lights up&down wall applique, easy to install and fit into any architectural context. ANTI-UV and V2 Self-extinguishing thermoplastic PC housing and diffusor and aluminium alloy bracket. Available in two finishes: white and black. Resistant to impacts.

1

⚠ WARNING

It is recommended to contact a qualified electrician to install the product.

It is recommended not to touch the product when it is turned on.

In case of malfunction, disconnect the lamp from the power supply. It is recommended to contact an electrician and not try to repair the lamp yourself.

MOUNTING

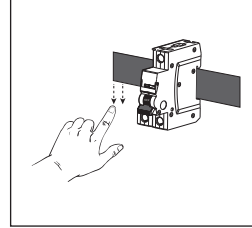

1. Switch off the power.

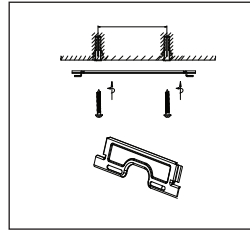

2. Choose the required position to install the bracket.

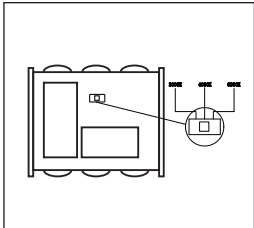

3. Select the color temperature and connect the power cable.

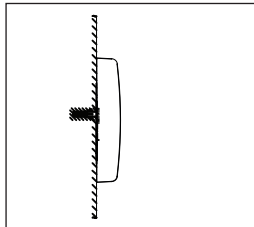
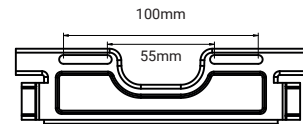

4. Push the product upward into the bracket.

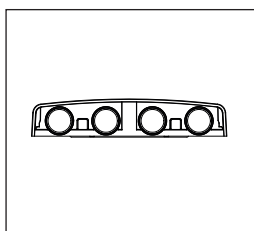

5. Fixture is ready to use.

Recycling Information in Accordance with the WEEE and Battery Directives



Product Mark



Battery Mark

Europe only

The product/battery is marked with one of the above recycling symbols. It indicates that at the end of the life of the product/battery, you should dispose of it separately at an appropriate collection point and not place it in normal domestic waste stream.

CE RoHs



IPERLUX®
www.iperlux.com
info@iperlux.com